

BERMAD Landscape

MT Series - Technical Specifications

Dimensions and Weights

Size	Inch	¾"	1"
L	mm	166	166
H	mm	145	145
W	mm	100	100
R	mm	25	25
Weight	Kg	0.60	0.65

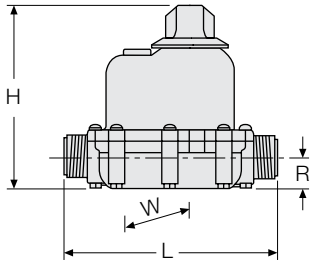

Flow Chart

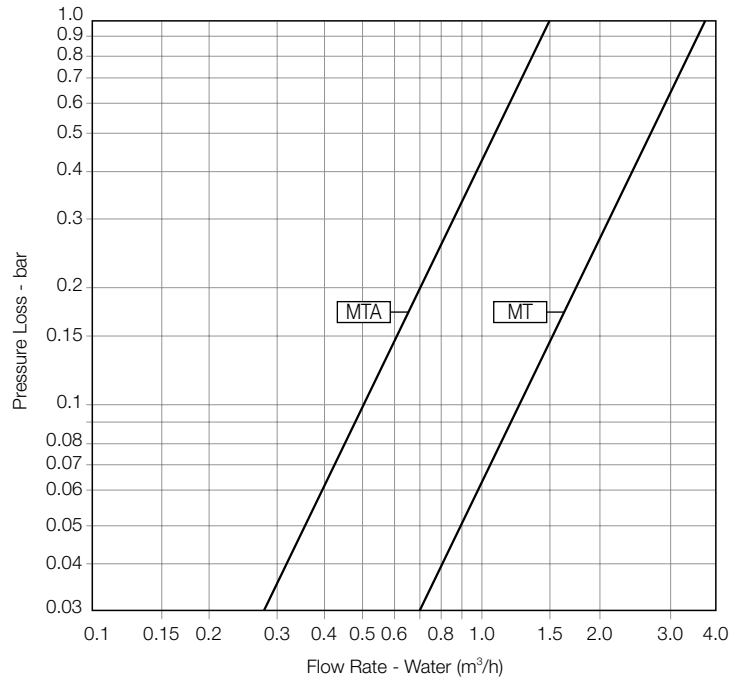

Flow Rate and Dial Capacity

Valve Category	Size		Nominal Flow Rate (m³/h)	Flow Rate (m³/h)		Dial Capacity	Graduation (liters)
	¾"	1"		Min	Max		
MT	•	•	3.0	0.5	5.0	100 Liter	2.5
						1000 Liter	25
						2000 Liter	50
						4-m³	100
						10-m³	250
						20-m³	500
						50-m³	1000
MTA	•	•	1.5	0.1	2.0	50 Liter	1
						500 Liter	10
						2000 Liter	50
						4-m³	100
						8-m³	200

Technical Data

Sizes: ¾" & 1"

End Connections: Male Threads BSP or NPT

Pressure Rating: ISO: PN6 ANSI: Class 90

Operating Pressure Range: 0.7-6 bar (10-90 psi)

Valve Category: MT - Normal flow

MTA - Low flow

Temperature Range: Water up to 80°C (180°F)

Accuracy of dosing: 2% of the max scale valve plus 4% of the set volume.

Meets ISO 7714 Class 3 requirements

32 Materials:

Base, Housing and Gear: Plastic

Shafts and Springs: Stainless Steel

Seals: EPDM and NBR



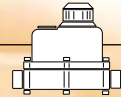

Automatic Metering Valves - Standard flow

Flow 0.5- 5.0 m³/h

Dial Capacity	Size		Cat. No.			
	Inch	mm		Units per Case	Weight (kg)	Volume (m ³)
1000 Liter	3/4"	DIN20	MT0071LIBP01000	12	8.90	0.0367
	1"	DIN25	MT0011LIBP01000	12	8.90	0.0367
2000 Liter	3/4"	DIN20	MT0071LIBP02000	12	8.90	0.0367
	1"	DIN25	MT0011LIBP02000	12	8.90	0.0367
4 m ³	3/4"	DIN20	MT0071M3BP00004	12	8.90	0.0367
	1"	DIN25	MT0011M3BP00004	12	8.90	0.0367
10 m ³	3/4"	DIN20	MT0071M3BP00010	12	8.90	0.0367
	1"	DIN25	MT0011M3BP00010	12	8.90	0.0367



Automatic Metering Valves - Low Flow

Flow 0.1-2.0 m³/h

Dial Capacity	Size		Cat. No.			
	Inch	mm		Units per Case	Weight (kg)	Volume (m ³)
50 Liter	3/4"	DIN20	MTA071LIBP00050	12	8.90	0.0367
	1"	DIN25	MTA011LIBP00050	12	8.90	0.0367
500 Liter	3/4"	DIN20	MTA071LIBP00500	12	8.90	0.0367
	1"	DIN25	MTA011LIBP00500	12	8.90	0.0367
2000 Liter	3/4"	DIN20	MTA071LIBP02000	12	8.90	0.0367
	1"	DIN25	MTA011LIBP02000	12	8.90	0.0367
4 m ³	3/4"	DIN20	MTA071M3BP00004	12	8.90	0.0367
	1"	DIN25	MTA011M3BP00004	12	8.90	0.0367
8 m ³	3/4"	DIN20	MTA071M3BP00008	12	8.90	0.0367
	1"	DIN25	MTA011M3BP00008	12	8.90	0.0367

